

New Hope for Families

Capital Campaign Preview Booklet



Join the hope movement!

April 9, 2021 | Bloomington, Indiana

New Hope for Families Capital Campaign Team

Capital Campaign Steering Committee

Sue Shindell, Chair	John Hurlow
Don Adams	Elizabeth McCrea
Chris Cockerham	John VanderZee

Capital Campaign Cabinet

Dan Peterson, Chair	Darby McCarty
Don Adams	Elizabeth McCrea
Jon Barada	Sylvia McNair
Chris Cockerham	Regina Moore
John Hurlow	Susan Rinne
Mark Kruzan	Sue Shindell
Gigi-Larmour-Goldin	

Board of Directors

Andrew Allard, President	John Hurlow, Secretary
Sherry Dunbar-Kruzan, Vice President	Robin Irie, Treasurer

Don Adams	Rob McCrea
Suzanne Fuson	Neil Powell
Amelia Lahn	Paul Quick
Craig Luginbill	Tom Schwen
Elizabeth McCrea	Amy Stolberg
	MaryAnn Valenta

Campaign Staff

Emily Pike, Executive Director
James Olsen, Director of Development
Thom Atkinson, Development Assistant



Family homelessness: A serious problem that harms our community

- The 2020 “Point In Time Count” estimates 39 families with 81 children are experiencing homelessness in Monroe County at any given time
- Linked to negative educational outcomes for children, limiting their opportunities for future success in school and in life
- Causes a decline in personal health of each member of the family
- Creates a public health problem for the entire community
- Perpetuates a cycle of poverty





Together we can solve
this.



We're inviting Bloomington's
community leaders to join
"the hope movement!"

Working with our **generous community partners**, provides the solutions we need

- Helping families find their path to stable housing
- Unique combination of emergency shelter and critical services
- Accredited childcare helps parents get back to work
- Compassionate and evidence-based model
- Unduplicated program
- Exceptional results



Measuring success

- About 80% of the families who stay in our shelter move on to stable housing after they leave. This compares to the state average of 52%.
- More than 90% of the parents who have children enrolled in our early childhood education program were able to gain or maintain employment.
- The only emergency shelter in the state of Indiana with onsite childcare rated Level IV Paths to Quality.
- During our first 9 years we served nearly 200 families, and helped over 500 children avoid foster care

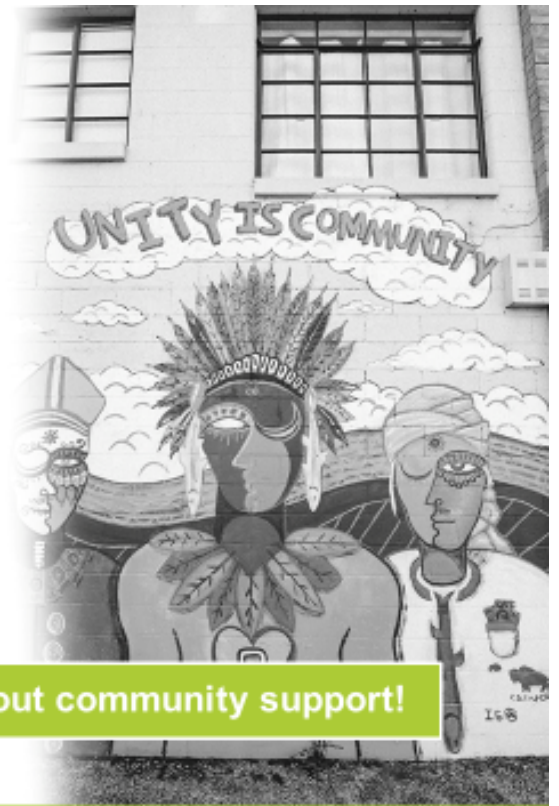

None of this would have been possible without community support!



None of this would have been possible without community support!

Family Values

We affirm that:

- Families are stronger together.
- Every family deserves a safe place to sleep.
- Every child deserves to begin school ready to succeed.
- Every parent in our community deserves to have access to safe and affordable childcare, so that gainful employment can be within reach.

This is what we stand for.



This is our moment

- New Hope currently operates at 100% capacity.
- Demand is increasing for shelter, childcare and our other services.
- New Hope is committed to grow, to better serve our community.
- Our current site becomes unavailable soon.

**We are GROWING
to MEET the NEED.**

Will you join us?



Bold Vision

New Hope for Families is committed to:

- Build a new facility to better serve the community
- Increase shelter capacity from 7 to 12 families
- Expand childcare from 16 to 48 children
- Be prepared to break ground in 2021

- We invite you to be our strategic partner!





Capital Plans

- Purchased property in August 2019
- ½ mile south of current location
- Convenient access to amenities

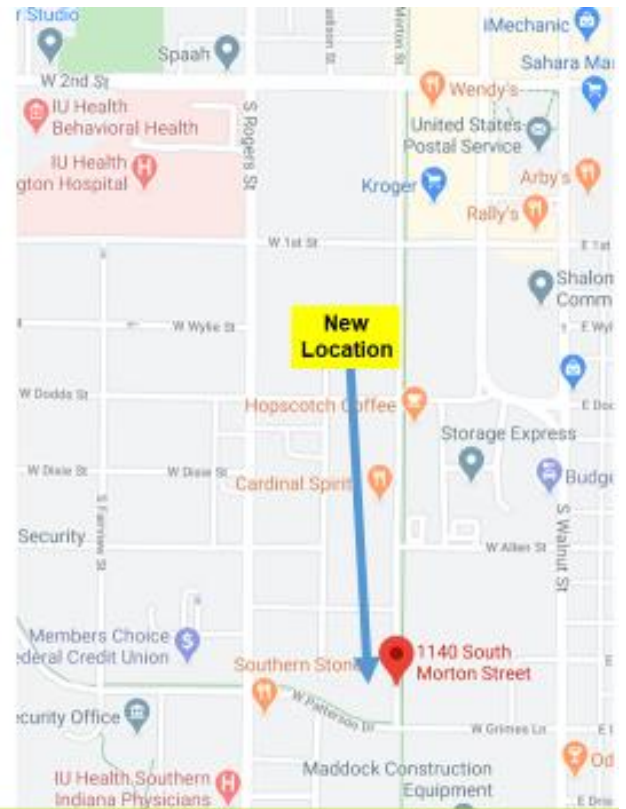

Site Map for 1140 S. Morton Street

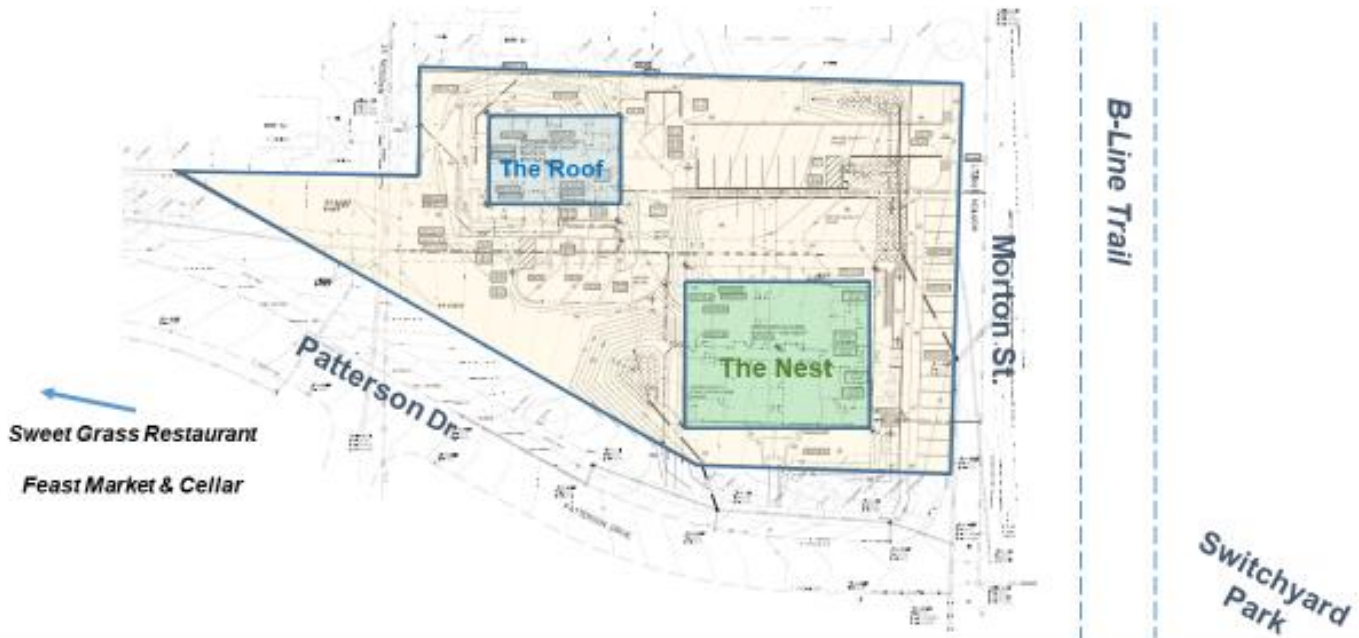

New Shelter Building

- Increased Shelter Capacity (Up to 12 families = 70% increase)
- 3 pods of four families each
- Mixture of private and shared spaces
- 2 levels + basement



Plan for first floor of New Shelter Building



Plan for second floor of New Shelter Building



Pod Layout: Safe, Supportive, Functional, Efficient



New Early Childhood Center Building



- Increased capacity (48 children = 200% increase)
- 4 age-specific classrooms (indoor and outdoor)
- Includes kitchen, offices, meeting rooms



Floor Plan for New Early Childhood Center Building

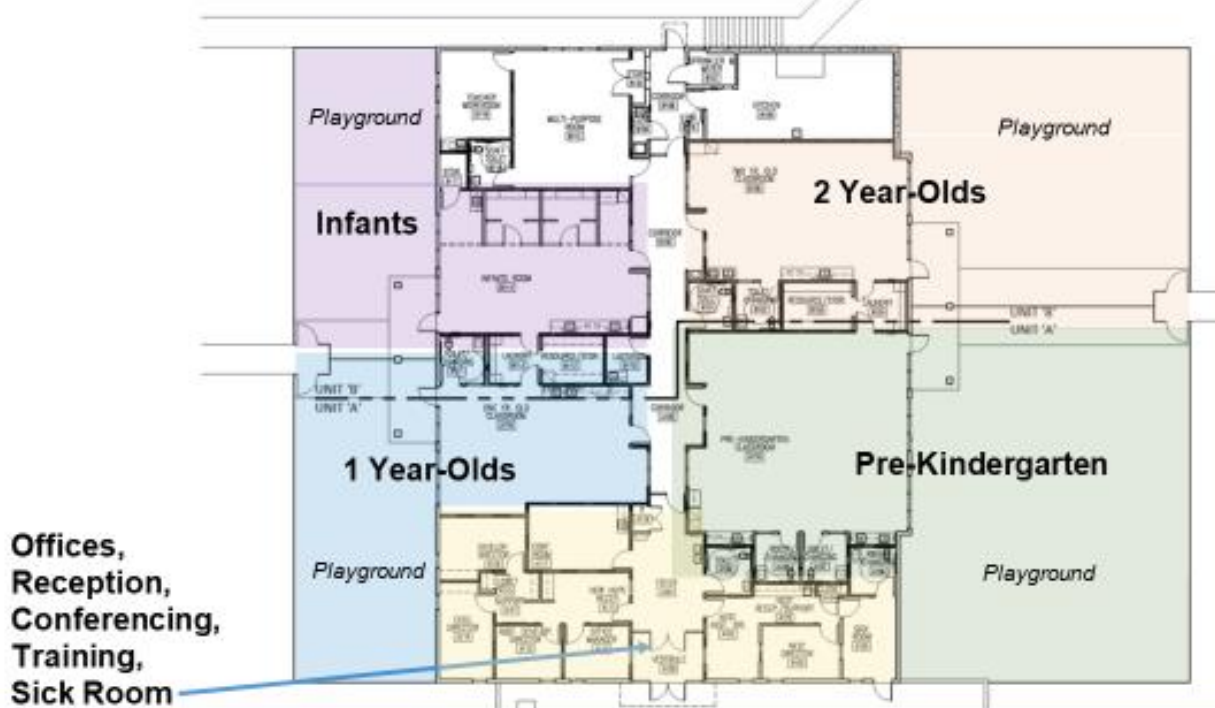

Campaign Budget

Capital campaign costs and goals

- Construction \$3.5M
- Land \$700K
- Capital Fund \$400K
- Furnishings \$250K
- Endowed Fund \$500K
- Operations scale up \$350K
- Total \$5.7M

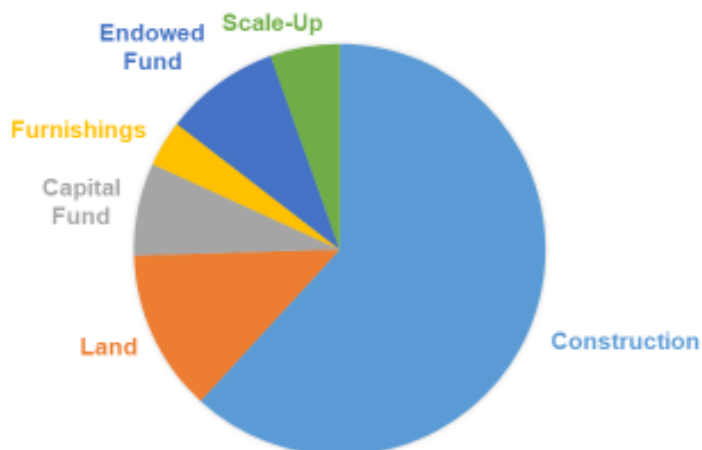

Impact of early commitments

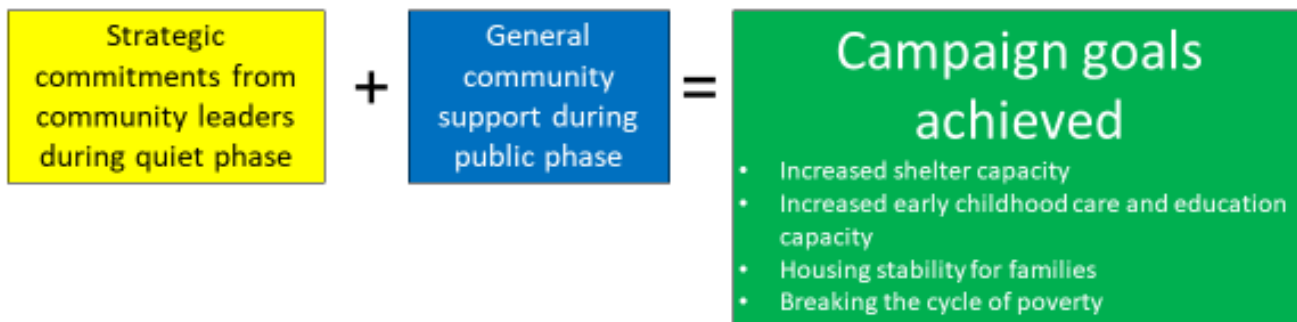



New Hope for Families

Board of Directors

(Updated April, 2021)

Officers

Andy Allard – President
COO, IU Credit Union
Former chair, Habitat for Humanity

Sherry Dunbar-Kruzan – Vice President
Training & Development Manager,
TASUS Corporation

John Hurlow – Secretary
Managing Partner & Financial Advisor, Hurlow
Wealth Management Group

Robin Irie – Treasurer
Finance Manager, The Cook Gr

Members

Don Adams
Retired Business Owner

Suzanne Fuson
Retired Global Marketing Director,
Dow Corning

Amelia Lahn
Founder and Partner
Lahn Law, LLC

Craig Luginbill
Retired Project Manager & Electrical Engineer

Liz McCrea
Emerita Faculty, Indiana University
Past President, American Speech-Language-
Hearing Association

Rob McCrea
Attorney, McCrea & McCrea

Neil Powell
Director, IU Kelley Strategic Finance Academy

Paul Quick
President, Smithville Communications

Tom Schwen
Emeritus Professor, Indiana University

Amy Stolberg
Speech & Language Clinician, MA CCC-SLP

MaryAnn Valenta
Director, Alignment and Integration
Indiana University Health

Melanie Walker
CEO & President, TASUS Corporation

**Together we can provide
Help for today & New Hope for tomorrow.**



SECRETLY CANADIAN



NEWHOPE
FOR FAMILIES

COMMUNITY
FOUNDATION
BLOOMINGTON • MONROE COUNTY



Marketing Committee

Steve Dyer
Suzanne Fuson
Paul Quick

Special thanks to John Mitchell Creative

Join the hope movement!



newhope4families.org